

DO NOT SCALE

0 10 100
Millimetres

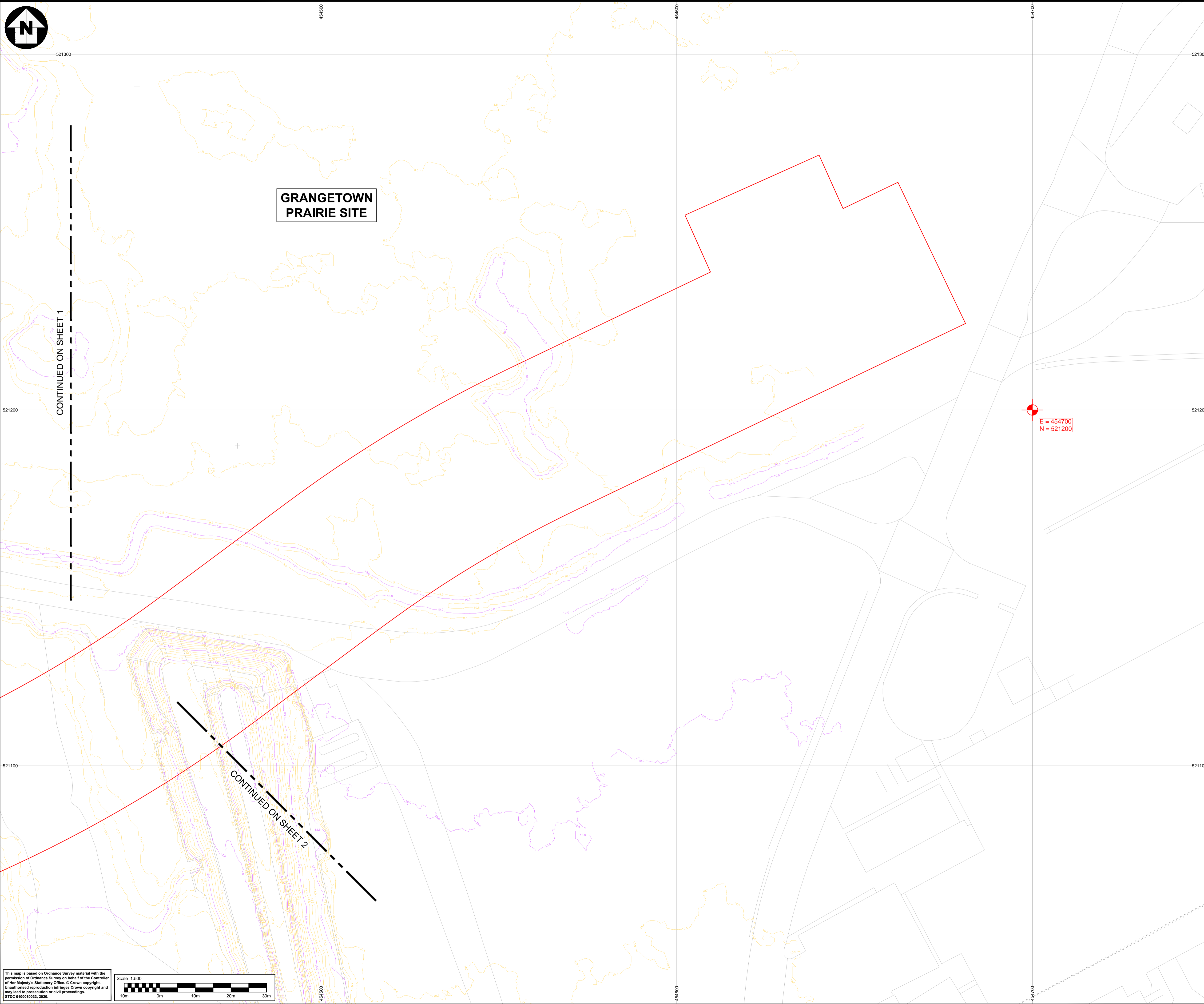

- KEY:**
- EXISTING ITEMS:**
- Traffic Bollard
 - Traffic Signal Pole
 - Traffic Sign
 - Lighting Column
 - Safety Barrier
 - Pedestrian Guardrail
 - Security Gates
 - Concrete Palisade Fence
 - Metal Palisade Fence
 - Route of Storm Drain
 - Route of Holme Beck Culvert
 - Drainage Headwall
 - Drainage Gully
 - Manhole / Stop Valve
 - Access Chamber
- CONTOURS:**
- Major Contour (2.5m)
 - Minor Contour (0.5m)
- BOUNDARY:**
- Planning Application Boundary

- NOTES:**
- On site topographic survey of existing not yet undertaken.
 - Indicative topographic survey items shown are taken from Google Street View and Asbuilt Construction Records from Eston Road / A66 Signalisation Scheme (2010) and are indicative of locations. All locations subject to formal topographic survey verification.
 - Spot heights and contours are indicative only using existing data freely available from the Environment Agency Data website at <https://environment.data.gov.uk/DefraDataDownload/?Mode=survey> using type: LIDAR-DTM-1M-NZ52sw. All level information subject to formal topographic survey verification.

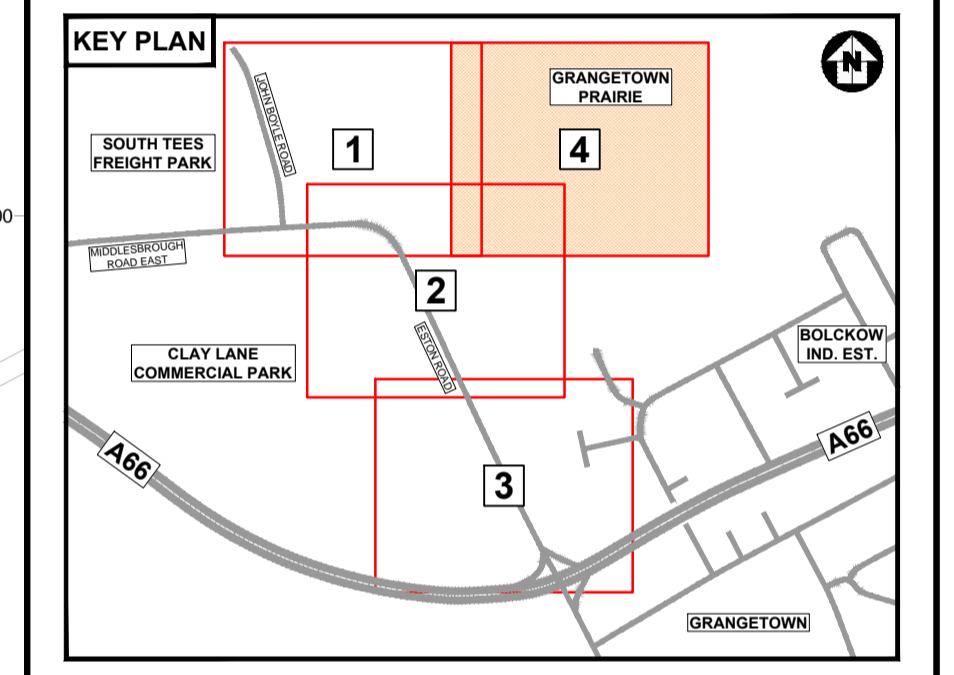

Description	Status	Revision	Drawn	Checked	Reviewed	Authorised	Issue Date
Description							
Description							
Description							
Description							

FOR PLANNING APPLICATION							Issue Date
Status	Revision	Drawn	Checked	Reviewed	Authorised	Issue Date	
A1	C01	MT	DS	MT	DS	10/06/20	

APPROVED - PUBLISHED A1

ATKINS
Member of the SNC-Lavalin Group

Dunedin House
Columbia Drive
Stockton-on-Tees
Cleveland
TS17 6BJ
Tel: +44 (0)1642 525200
www.atkinsglobal.com

Copyright © Atkins Limited (2020)

Client

STDC
Teesside Management Offices,
Redcar, TS10 5QW
www.southteesdc.com

Project Title
SOUTH TEES DEVELOPMENT CORPORATION

Drawing Title
**PRAIRIE SITE ENABLING WORKS
PLANNING APPLICATION
EXISTING SITE LAYOUT PLAN
1-500 LAYOUT (SHEET 4 OF 4)**

Drawing Number	Project	Originator	Volume
STDC_HWY	ATK	LDC	
PR	DR	CH	000013
Location	Type	Role	Number
A1	Scale: 1:500	Project Ref. No.: 5198022	Sheet: 4 of 4
Original Size:	Scale: 1:500	Project Ref. No.: 5198022	Sheet: 4 of 4
Original Size:	Scale: 1:500	Project Ref. No.: 5198022	Sheet: 4 of 4
Original Size:	Scale: 1:500	Project Ref. No.: 5198022	Sheet: 4 of 4

This map is based on Ordnance Survey material with the permission of Ordnance Survey on behalf of the Controller of Her Majesty's Stationery Office. © Crown copyright. Unauthorised reproduction infringes Crown copyright and may lead to prosecution or civil proceedings. STDC 10/06/2023, 2020.

